

British Instantaneous Fittings



BIE150



BIC150

Hose Shanks

Size	Brass Part #
2-1/2" male BRIT x 1-1/2" hose shank	BIE150
2-1/2" male BRIT x 2-1/2" hose shank	BIE250
2-1/2" female BRIT x 1-1/2" hose shank	BIC150
2-1/2" female BRIT x 2-1/2" hose shank	BIC250

Plug



Size	Brass Part #
2-1/2"	BIDP250

Cap



Size	Brass Part #
2-1/2"	BIDC250

International Shore Connections

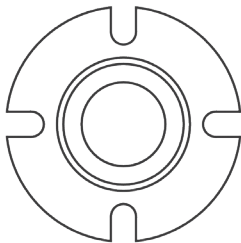

ship connection
09-319

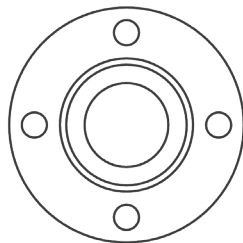

shore connection
09-318

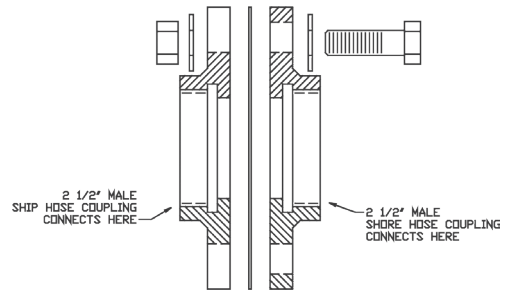

Size

- 7" O.D. brass flange with 4-3/4" holes

Applications

- Makes possible the connection of two different threads between ship and shore or between ships

Feature

- Includes 8 washers, 4 hexagon brass nuts, 4 hex head bolts, 1 washer, 1 fiber gasket

Specifications

- Working pressure: **300 PSI**
- NST (NH) threads standard, also available in NPT and NYFD threads

Approval

- Meets U.S. Coast Guard specifications for vessels 1000 gross tons or more



09-318-00001



09-319-00001

Description	Brass Part #
shore side	09-318-00001
ship side	09-319-00001

N